

# NNLA Landscape Award

*Recognizing the work of our members*

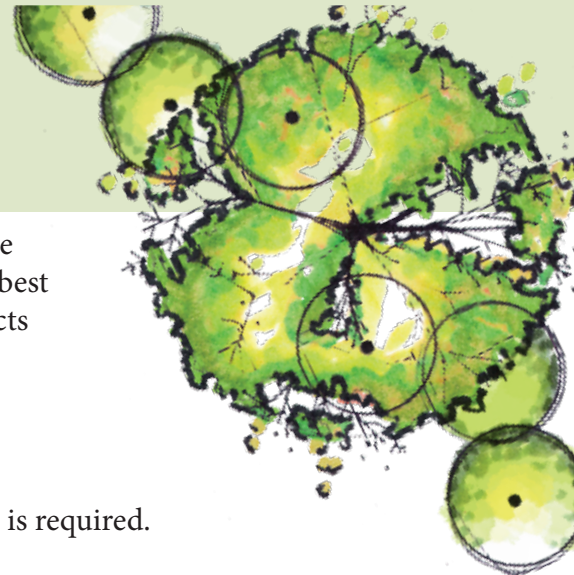

The NNLA Landscape Awards Program is an opportunity for excellence in the landscape industry to be recognized. Everyone is encouraged to submit their best projects to be juried by a panel of industry experts. The award-winning projects will be showcased at the Nebraska GREAT PLAINS Conference.

## CATEGORIES

### **CATEGORY 1: Residential Installation Under \$15,000**

Submit 8-20 project photos and a written description. No plan is required.

### **CATEGORY 2: Residential Installation \$15,000 - \$50,000**

Submit 8-20 project photos and a written description. No plan is required.

### **CATEGORY 3: Residential Installation \$50,001 +**

Submit 8-20 project photos and a written description. No plan is required.

### **CATEGORY 4: Use of Seasonal Color, Container Gardens or Perennial Gardens**

Seasonal color entries must include images depicting a progression of seasonal color on a single client's project. Seasonal color or container garden entries could include window boxes, patio planters, street planters, etc. and may include the use of annuals, perennials, bulbs, etc. Perennial garden entries must feature the predominant use of perennials and/or grasses, with 8-20 project photos and a written description. Plans or plant lists are not required.

### **CATEGORY 5: Theme Gardens or Retail Displays of Horticultural Products or Services**

Projects may include permanent or temporary installations or product/merchandise displays, such as: displays at garden centers or in landscapes; landscape or garden center company headquarters; garden show, mall, trade show, or state/county fair displays; knot gardens; butterfly gardens; rock gardens; dwarf conifer gardens; etc. No plan is required. Submit 8-20 project photos and a written description that states the intended theme.

### **CATEGORY 6: Student Project**

Students, individually or as a team, are encouraged to submit creative designs while being mindful of the practical considerations of site opportunities and constraints, program requirements, local government rules, and environmental issues. Students are not restricted by a design and construction budget. Entrants should submit a landscape plan, maximum size 24"x36", for a garden or residence. All plants and hardscape elements must be clearly labeled. The plan should be drawn to scale and include a graphic scale and north arrow. Additional supporting drawings such as elevations, details and perspective sketches may also be included. No student names or the name of any school should appear on the plan. Print or high resolution digital images of plans may be submitted. All entrants must be NNLA student members. A list of all team members must be submitted with the entry form.

## RULES

**Eligibility:** This program is open to all NNLA members and non-members. Projects are eligible up to 6 years after installation. Entrants must have executed or designed the majority of the project. Projects can be re-entered in the same category in a following year unless the project received a top NNLA award.

**Copyrights & Client Permission:** The entrant assumes the responsibility of copyrights, photographic fees and client permission for further use of images by NNLA for public relations purposes. NNLA is not responsible for the pictures selected or any edited copy used from the files sent to the media. Entries become the property of NNLA and may be used for publication or other purposes deemed appropriate.

**Entry Fee:** There is a \$35 fee for initial entries and a \$25 fee for additional entries for NNLA members. For non-members there is a \$75 fee for initial entries and \$50 fee for additional entries. Students may provide entries for free.

## RULES

**Recognition:** Winners will be honored and recognized during the Nebraska GREAT PLAINS Conference. A commemorative plaque will be provided to winners in each category. Winning project photos will be featured on the NNLA website, Facebook page and newsletter.

**Judging & Awards:** Awards will be granted in each category when warranted based on a points system. Points are awarded by a panel of judges for each entry. If entries do not reach the appropriate score, no award will be offered. Three judges, who are experienced in the landscape field and not directly involved with the NNLA, will evaluate all entries.

## TO ENTER

**Email:** Send completed application to [tfougeron@youraam.com](mailto:tfougeron@youraam.com). Instructions will then be provided to submit photos.

**Deadline:** December 15.

Use a separate entry form for each entry. This form must be completely filled out and accompanied by a written description of all photos for the submitted project to be considered.

Contact Name: \_\_\_\_\_

Company Name: \_\_\_\_\_ If Selected, Name to Appear on Award: \_\_\_\_\_

Address: \_\_\_\_\_ City: \_\_\_\_\_ State: \_\_\_\_\_ Zip: \_\_\_\_\_

Phone: ( ) \_\_\_\_\_ Email: \_\_\_\_\_

Category Number: \_\_\_\_\_ Category Name: \_\_\_\_\_ Project Name: \_\_\_\_\_

Total Amount for Contracted Work: \$ \_\_\_\_\_ Year of Installation: \_\_\_\_\_

*The entrant assumes the responsibility for copyrights, photographic fees and client permission for further use of images by NNLA for public relations purposes. NNLA is not responsible for the pictures selected or any edited copy used from the press package sent to media. Entries become the property of NNLA and may be used for publication or for any other purpose the association deems appropriate. I verify that all information contained on this entry form is accurate. I further verify that no alterations of any kind have been made to the images I've submitted for this entry.*

Signature: \_\_\_\_\_

Initial Entry: \_\_\_\_\_ x \$35 (NNLA Members)  
Additional Entries \_\_\_\_\_ x \$25 (NNLA Members)  
Initial Entry \_\_\_\_\_ x \$75 (non-members)  
Additional Entries \_\_\_\_\_ x \$50 (non-members)  
Number of Entries \_\_\_\_\_ x FREE (NNLA Student Members)  
Total Enclosed: \$ \_\_\_\_\_  
Check Enclosed \_\_\_\_\_  
VISA \_\_\_\_\_ MasterCard \_\_\_\_\_

Card Number: \_\_\_\_\_

Expiration Date: \_\_\_\_\_ CVV Code: \_\_\_\_\_

Signature: \_\_\_\_\_

## CHECKLIST

- Completed entry form
- Entry fee
- 8-20 high resolution photos in JPEG format
- No company names or logos on photos
- Written project description

**DEADLINE: December 15**

## Questions:

email [tfougeron@youraam.com](mailto:tfougeron@youraam.com)  
or call (402) 761-2216